

ST KILDA ROAD

GRANT STREET

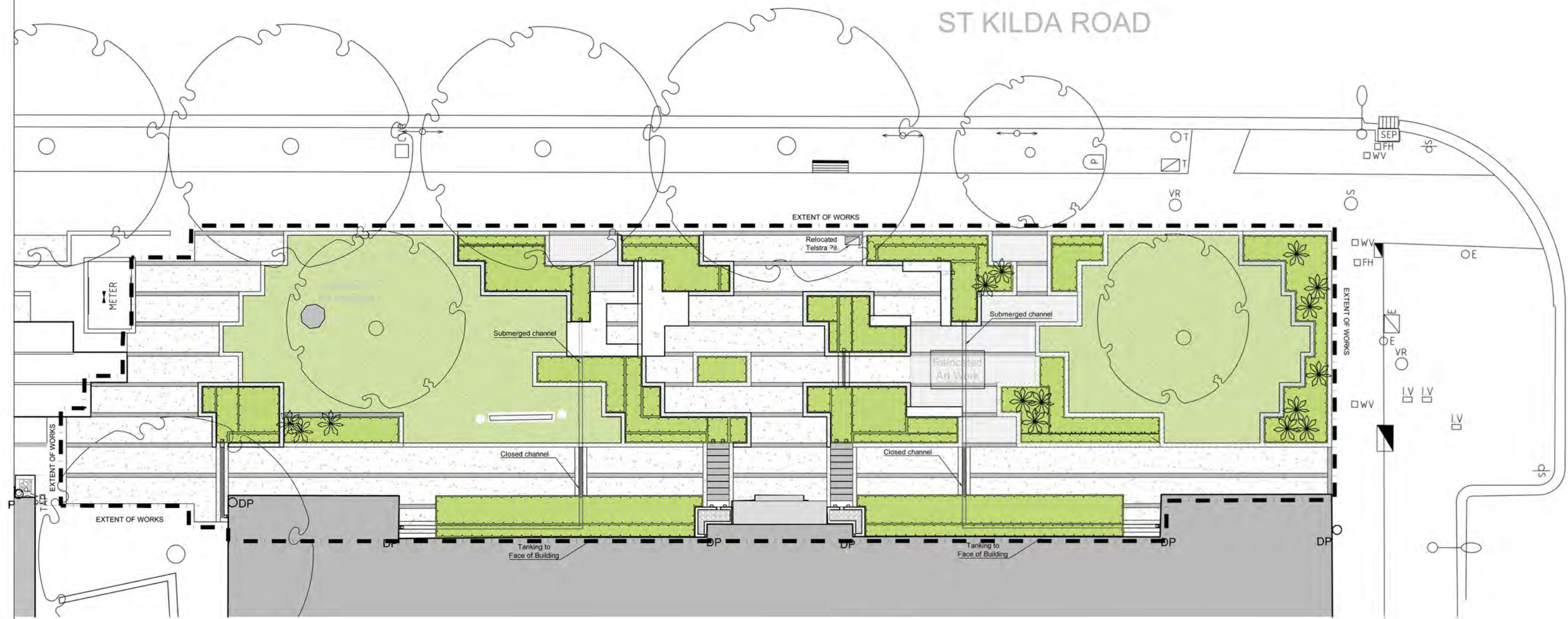

Legend

- Raingarden - Profile**
6m² tubestock planting
50mm inorganic mulch
350mm sandy loam
100mm sand
150mm crushed rock screenings
- Garden beds**
- Mulched Zone**
100mm depth Bark King - Multibark - hammermilled Pine Bark
- Existing tree to be retained**
- Paving Area**
100mm depth coloured concrete
50mm FCR basecourse
- Bluestone Paving**
Sawn bluestone 200mm wide strip paving
- Raised Concrete Platform**
150-450mm height
- In situ concrete channel with custom grate**
Carries water from downpipe to gal/steel feature spout in raingarden wall
- DP** Existing Downpipe
- 350mm(ht) Concrete catchment pit**
with gravel mulch infill and bluestone detailing
- Concrete mowing strip**
- 0-110mm/ht concrete edge**
- Raingarden Retaining Wall**
800mm max. height
(to faces of raingardens below existing surface level)
- Proposed Feature Plant**
Doryanthes excelsa
- B1** Raingarden/Gardenbed Reference No.
- Proposed Gravel**
10mm Granitic Gravel
40mm depth loose
60mm compacted (no fines)

Designed 01.05.07

Checked

Authorised RPC

Map Reference Melway 43 J11
Sheet Number 5 of 34
Drg Status CONSTRUCTION

VCA - St Kilda Road Frontage - STAGE 1

Landscape Construction Drawings
General Layout Plan
Melbourne University
City of Melbourne

Rev 0
Drg No 141290 LCD05

coomes consulting



file name 141290819_LCD_setout.dwg layout name 141290 LCD05
file location G:\14141290819_VCA\acad
plotted by Alexandra Lee plot date 23/5/2007 2:59 PM
© Coomes Consulting Group Pty Ltd
Standard Drawing RDA1 - Version 20070420



Rev	Amendments	App'd	Date
0	Issued for Construction	AL	2007-05-23
E	Raingarden B5 and GB9 revised and Kerb Junctions amended	AL	2007-05-22
D	Wall Types redefined	AL	16.05.07
C	Open channels and raingarden walls removed adjacent to trees	ST	2007-05-14
B	Design amendments post aborist advice	AL	2007-05-11
A	Legend Amended	AL	2007-05-08